

This drawing is the property of the UNIVERSITY OF GLASGOW and must not be reproduced without permission from the UNIVERSITY COURT.
 THE CONTRACTOR must check all dimensions before commencing site work or shop drawings and any discrepancies brought to the attention of the DIRECTOR OF ESTATES AND BUILDINGS.
 DO NOT SCALE FROM THIS DRAWING

Notes:

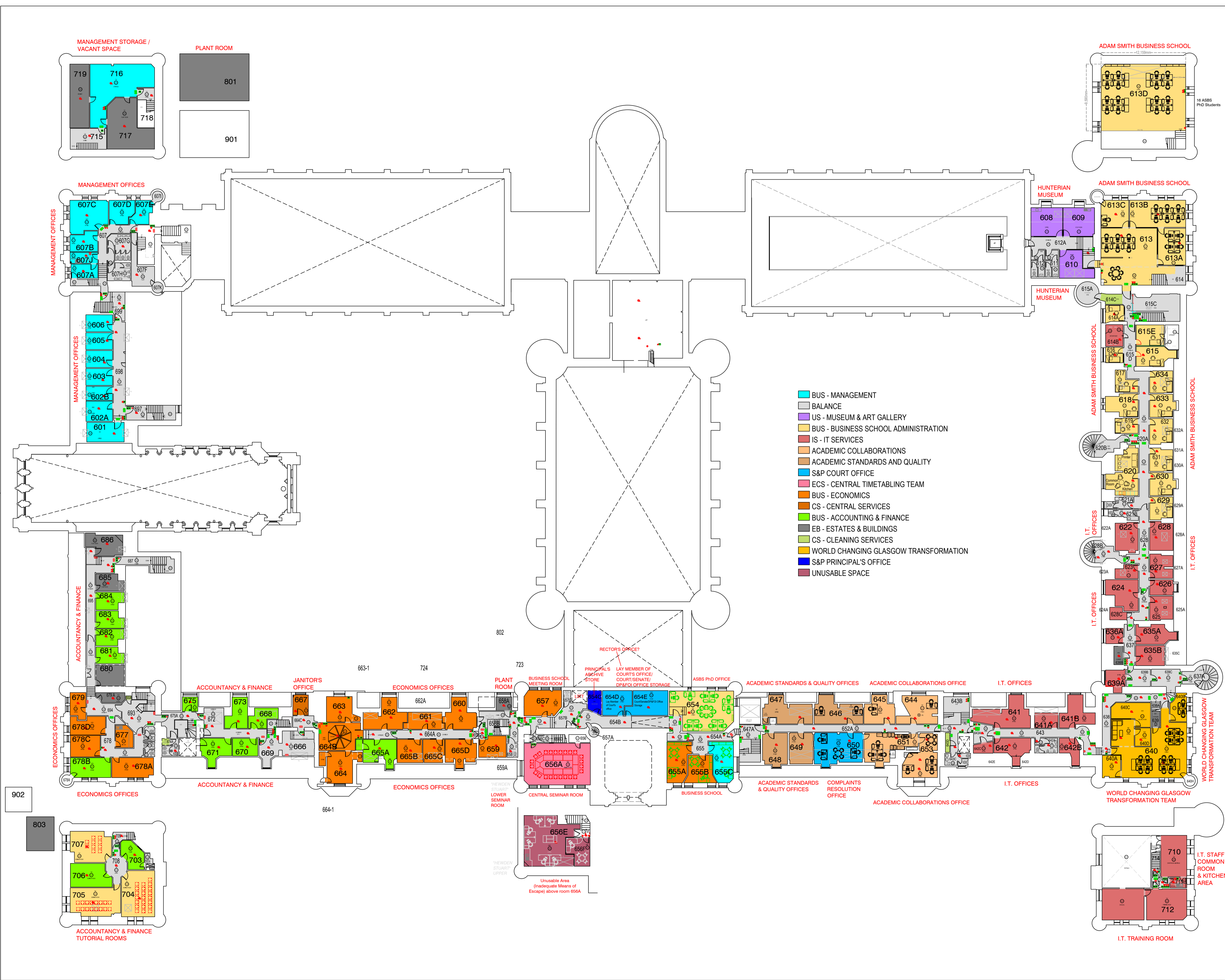

- BUS - MANAGEMENT
- BALANCE
- US - MUSEUM & ART GALLERY
- BUS - BUSINESS SCHOOL ADMINISTRATION
- IS - IT SERVICES
- ACADEMIC COLLABORATIONS
- ACADEMIC STANDARDS AND QUALITY
- S&P COURT OFFICE
- ECS - CENTRAL TIMETABLING TEAM
- BUS - ECONOMICS
- CS - CENTRAL SERVICES
- BUS - ACCOUNTING & FINANCE
- EB - ESTATES & BUILDINGS
- CS - CLEANING SERVICES
- WORLD CHANGING GLASGOW TRANSFORMATION
- S&P PRINCIPAL'S OFFICE
- UNUSABLE SPACE

Date	Revisions

University of Glasgow | Estates & Buildings
 University Ave
 Glasgow
 G12 8QQ
 0141 339 8855/330 6000

JOB TITLE
Main Building

Drawing Title:
Level 6

Date	March 2019	Scale	1:250 at A1 size
Drawn		Checked	

Drawing No. **104/06** Rev.